

CUSTOMER DRAWING

REVISIONS

LTR	DESCRIPTION	DATE
PA1	INITIAL RELEASE	2019-06-19

SOLDER WELL DATA

CONTACT SIZE	20
WELL DIAMETER	.046 ^{+.004} _{-.000}
WELL DEPTH	.125 ^{+.031} _{-.000}

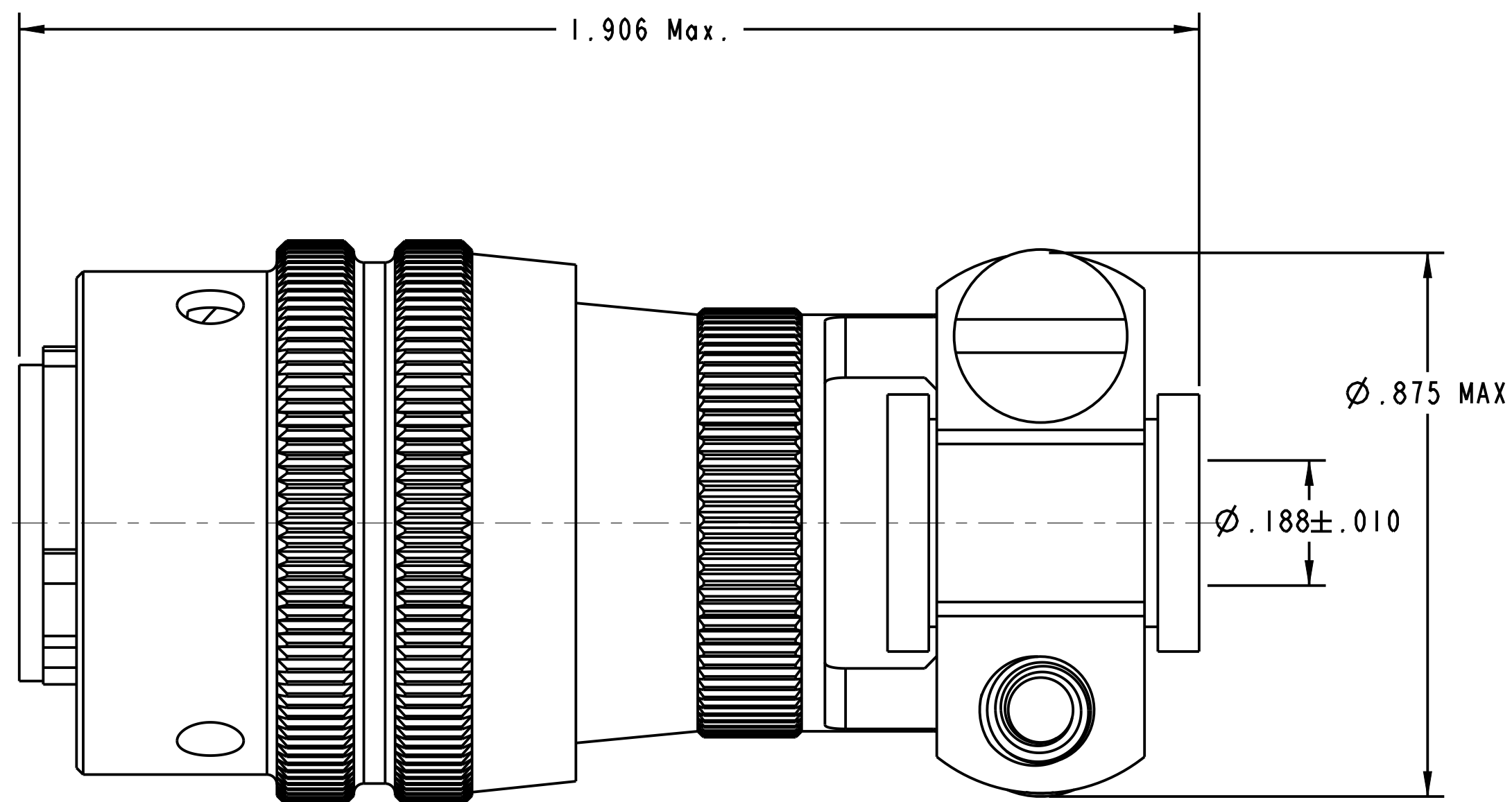
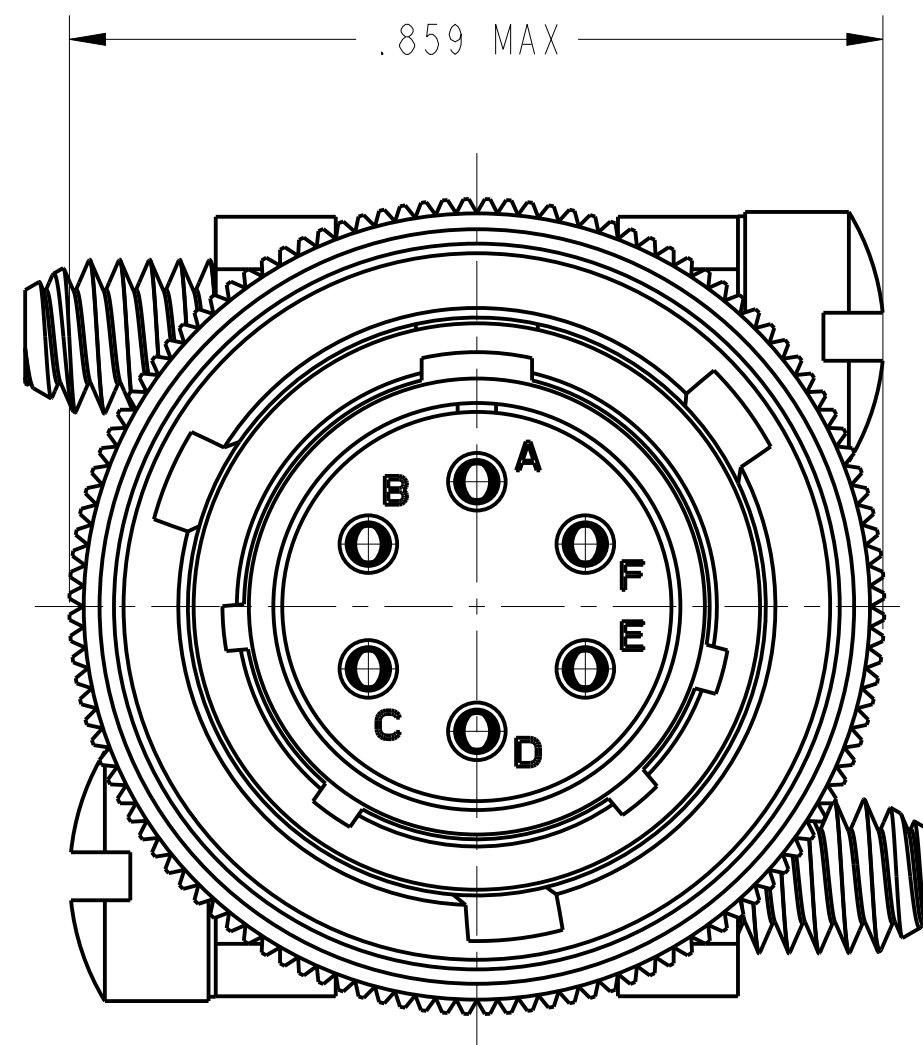

SPECIFICATION

CONTACT TEST CURRENT	7.5 Amps
OPERATING VOLTAGE	600 VAC MAX
OPERATING TEMPERATURE	-55°C TO 125°C
SALT SPRAY	5%NaCl, 500h
DURABILITY	500 CYCLES

NOTES:

THE USE OF THIS DOCUMENT IS UNLIMITED. HOWEVER, DOCUMENTS REFERENCED HEREON MAY CONTAIN LIMITED RIGHTS DATA.

PRO/ENGINEER INFORMATION	
N/A	Pro/e Model Used:
N/A	10-679974-000.ASSEM
N/A	Drawing Name:
N/A	PT06E-10-6S-072-SR
N/A	NEXT ASSEMBLY

UNLESS OTHERWISE SPECIFIED	SPECIFICATIONS	POS	QTY	PART NUMBER	DESCRIPTION	NOTE
LINEAR DIMENSIONS ARE IN INCHES TOLERANCES: .XXXX = ±.0005 ANGLES= ±2° .XXX = ±.010 .XX = ±.03 .X = ±.1 DIM. & TOL. PER ASME Y14.5M; DRM PER MIL-DTL-31000; OTHER Amphenol Sds. PER 9-3800 LEGENDS: =FLAG NOTE CALL OUT REFERENCE ONLY	MATERIAL SPEC.	APPROVALS		DATE	PARTS LIST	
	N/A	PREPARED BY	Henry He		AMPHENOL CORPORATION 40-60 DELAWARE AVENUE SIDNEY, N.Y. 13838	
PROCESS SPEC.	N/A	ENGINEER IN CHARGE	Sunny Qin	Jun-19-19	CONNECTOR PLUG, TYPE PT06E-10-6S(072)(SR), CONDUCTIVE GRAY ZINC NICKEL PLATING	
		DESIGN MANAGER	RAN XIAO		SIZE C CAGE CODE 77820 DOCUMENT NO. PT06E-10-6S(072)(SR) REV. PA1	
		DESIGN ACTIVITY GROUP	C3		SCALE: 1.0 REF: SHEET 1 OF 1	
		THIRD ANGLE PROJECTION				